

1144 SERIES KEY FOB TRANSMITTERS

Installation Guide

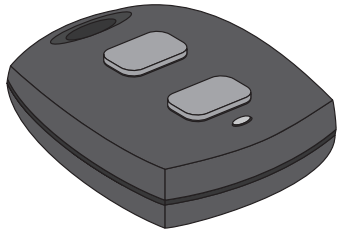

Figure 1: 1144-D Key Fob

DESCRIPTION

The 1144 Series Wireless Key Fobs include the 1144-1 One-Button, 1144-2 Two-Button, 1144-D Dual-Button, and 1144-4 Four-Button transmitters.

Each key fob features a durable water-resistant housing designed to be clipped to a key ring or lanyard, ergonomic button design, and a status LED that indicates system status with color-coded responses, as well as built-in optional 128-bit AES encryption.

Variants include models with a 1306P Prox Patch™ credential or panic supervision mode. For more information, refer to “Ordering Information”.

What is Included?

- One Key Fob Transmitter with extra serial number label
- One 1306P Prox Patch credential (1144-1P only)
- One Sony® CR2430 3.0 V Lithium Coin Battery
- Peel-off Button Labels (not included with 1144-D)



OPERATION

Each button on the 1144-1, 1144-2, and 1144-4 can be individually programmed for one of nine different actions. The 1144-D provides two buttons that, when pressed at the same time, send a panic message to the control panel for annunciation.

Figure 2 shows the key fob button configurations. Table 1 shows the default programming for each button.

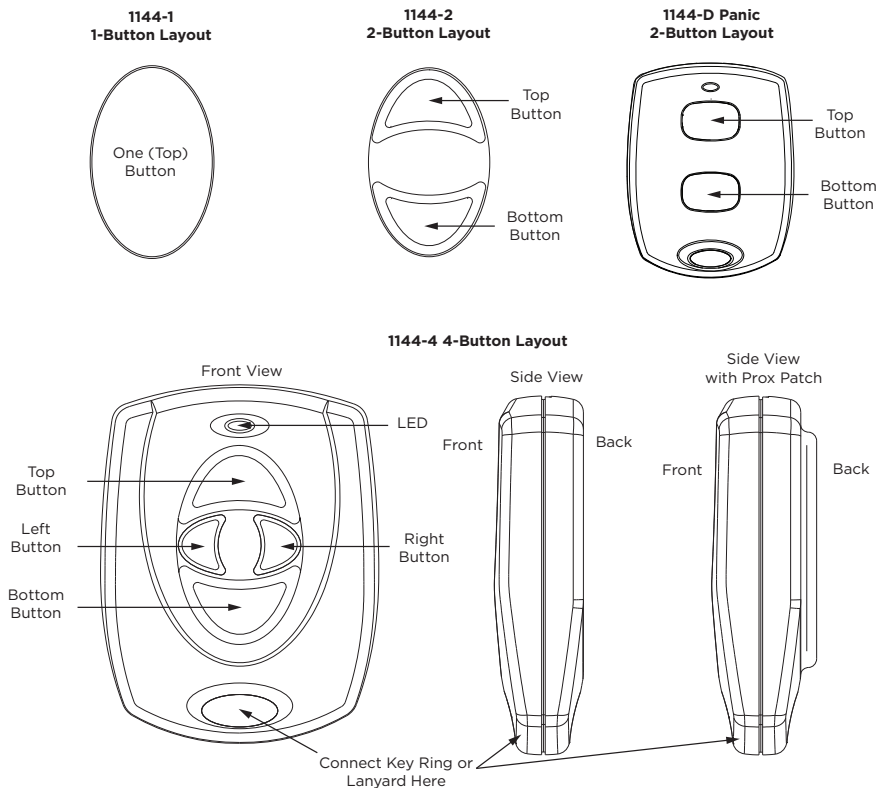

Figure 2: 1100 Series Key Fob Transmitters

KEY FOB MODEL	BUTTON POSITION	DEFAULT PROGRAMMING
1144-1 One-Button	Top	Panic
1144-2 Two-Button	Top	Arm
	Bottom	Disarm
1144-D Panic Dual-Button	Top and Bottom together	Panic 2
1144-4 Four-Button	Top	Arm
	Bottom	Disarm
	Left	Panic
	Right	Arm Area 1 or Perimeter

Table 1: Default Key Fob Programming

1 PROGRAM THE PANEL

Remove the Battery Isolation Tab

To activate the battery, remove the battery isolation pull tab. When removed, the key fob will be active and may be programmed into the system. See Figure 3.

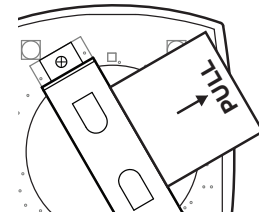

Figure 3: Battery Isolation Tab

Program the Key Fob

After completing each of the following steps, press **CMD** to advance to the next option. Refer to the appropriate panel programming guide as needed.

1. At a keypad, enter **6653** (PROG) to access the Programmer Menu.
2. Go to **ZONE INFORMATION** and enter the wireless zone number. Refer to Table 2 for zone numbers.
3. (XT30/XT50 panels only) At **KEYFOB** select **YES**.
4. At **KEY FOB USER NUMBER**, enter an existing user number to be associated with the key fob. If the user does not exist, the keypad displays **USER X NOT IN USE**. The key fob can be programmed, but the user must be created for it to function properly.
5. At **TRANSMITTER SERIAL#**, enter the eight-digit key fob serial number.
6. At **TRANSMITTER SUPRVSN TIME**, select a supervision time for the key fob. The default is **0** minutes. For applications where the key fob may be taken off-site, supervision time should be set to **0** (zero).

PANEL MODEL	ZONE NUMBERS
XR Series	400-449
XT30/XT50	31-34 41-44
XT75	400-449
XTL Series	51-54 61-64

Table 2: Key Fob Zone Numbers

To enable encryption, complete the steps below:

1. Go to **SYSTEM OPTIONS**. At **1100 ENCRYPTION**, select **ALL** to only add encrypted wireless devices to the system. Select **BOTH** to allow both encrypted and non-encrypted wireless devices to be programmed.
2. The default passphrase is displayed at the **ENTER PASSPHRASE** prompt. Press **CMD** to keep the default. Press any select key or area to change the passphrase and enter an 8-character hexadecimal string (0-9, A-F).



Note: To enable panic supervision for the 1144-1P-PSV on XR Series panels, go to **SYSTEM OPTIONS**. At **PANIC SUPERVISION**, select **YES**.

Program Key Fob Buttons

Refer to Table 3 when programming button actions.

1. At **NO. OF KEY FOB BUTTONS**, enter the number of buttons on the key fob (1, 2, or 4).
2. At **BUTTON**, select the button that you want to program: **TOP**, **BTM**, **LFT**, or **RGH**.
3. At **BUTTON ACTION**, choose an action for the button.
4. Configure press time or output options as needed.
5. Repeat the steps in this section as needed for each key fob button.

ACTION	SELECT	OPTIONS
Arm	ARM	Short/Long Press, Arm/Disarm Areas
Disarm	DIS	Short/Long Press, Arm/Disarm Areas
Toggle	TGL	Short/Long Press, Arm/Disarm Areas
Status LED	STA	Short/Long Press
Panic	PN	Output Number, Output Action
Panic (2-button)	PN2	Output Number, Output Action
Emergency	EM	Output Number, Output Action
Emergency (2-button)	EM2	Output Number, Output Action
Output	OUT	Output Number, Output Action
Sensor Reset	RST	Short/Long Press
Unused	UN	-

Table 3: Key Fob Button Programming Information

Program the 1144-1P Credential

Present the credential to a keypad or card reader to program the user credential. For information about adding user codes, refer to the panel user guide.

2 LABEL THE KEY FOB

Attach the key fob to any key ring or lanyard. Select the peel-off labels that display button programming and place them onto the corresponding key fob buttons. For easier label installation, use a small flat head screwdriver or hobby knife to select the label and apply it to the proper button location. Button labels can be changed if programming is changed. Button labels are not included with the 1144-D.

ADDITIONAL INFORMATION

When a receiver is installed, powered up, or the panel is reset, the supervision time for transmitters, including key fobs, is reset. If the receiver has been powered down for more than one hour, wireless transmitters may take up to an additional hour to send a supervision message unless a button is pressed. This operation extends battery life. A missing message may display on the keypad until the key fob sends a supervision message.

LED Status Operation

Depending on the programmed action of a key fob button, the Status LED turns on to acknowledge a button press or to indicate the armed state of the system. For best results, allow the LED to turn on and then turn off before pressing another button.

When the button is programmed for Panic, Panic 2, Emergency, Emergency 2, Output, or Sensor Reset, a 1/2 second green flash occurs to acknowledge the button press.

When the button is programmed for Arm, Disarm, Toggle Arm/Disarm, or Status, the system armed status is received by the key fob and the LED pulses once, as shown in Table 4. The LED does not operate when a button programmed as Unused is pressed.

LED COLOR	DURATION	DESCRIPTION
Red	2.0 Seconds	All System On
Green	2.0 Seconds	All System Off
Green/Red	2.0 Seconds	System On (Some Areas Armed)

Table 4: LED Operation

Replace the Battery

The 1144 Series Key Fob reports a low battery condition by automatically testing for a low battery on a daily basis. When replacement of the key fob battery is necessary, a **LOBAT** message will display on the keypad. Refer to Figure 4 when replacing the battery.

Observe polarity when installing the battery. Use only DMP Model CR2430 3.0 V coin cell batteries or equivalent Sony CR2430 battery from a local retail outlet.

1. Insert a small flathead screwdriver into the slot at the key fob end opposite the key ring and twist to separate the sections.
2. Push on the button area to remove the PCB and elastomer from the hard plastic case.
3. Gently roll the corner of the elastomer wall down then push and slide the old battery out of the holder in the direction of the arrow.
4. Verify the positive side of the battery is up and slide the new CR2430 Lithium battery into the holder and push it into place.
5. Roll the corner of the elastomer wall around the PCB and replace in the front hard plastic case.
6. Snap the front and back sections back together.

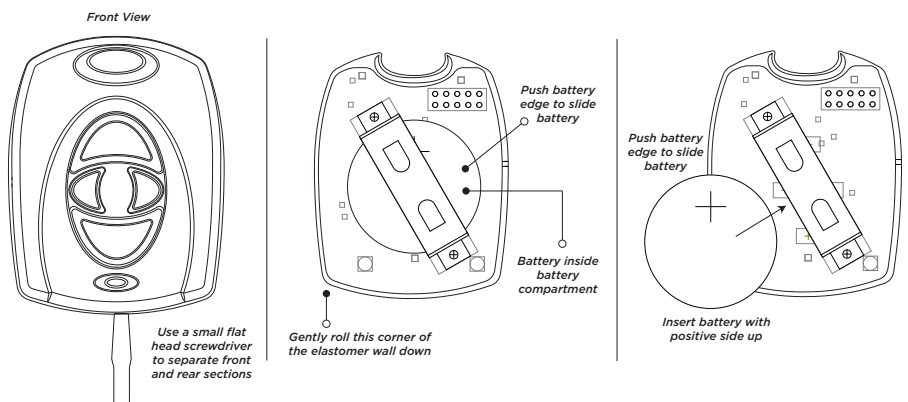

Figure 4: 1100 Series Key Fob Transmitters

Perform a Sensor Reset to Clear LOBAT

1. Once the battery is replaced, a sensor reset is required at the keypad to clear the **LOBAT** message.
2. On an LCD keypad, press and hold 2 for two seconds. On a graphic touchscreen keypad, press **RESET**. Enter your user code, if required. The keypad displays **SENSORS OFF** followed by **SENSORS ON**.

FCC INFORMATION

This device complies with Part 15 of the FCC Rules. Operation is subject to the following two conditions:

1. This device may not cause harmful interference, and
2. this device must accept any interference received, including interference that may cause undesired operation.

The antenna used for this transmitter must be installed to provide a separation distance of at least 20 cm (7.874 in.) from all persons. It must not be located or operated in conjunction with any other antenna or transmitter.

Changes or modifications made by the user and not expressly approved by the party responsible for compliance could void the user's authority to operate the equipment.

 **Note:** This equipment has been tested and found to comply with the limits for a Class B digital device, pursuant to part 15 of the FCC Rules. These limits are designed to provide reasonable protection against harmful interference in a residential installation. This equipment generates, uses and can radiate radio frequency energy and, if not installed and used in accordance with the instructions, may cause harmful interference to radio communications. However, there is no guarantee that interference will not occur in a particular installation. If this equipment does cause harmful interference to radio or television reception, which can be determined by turning the equipment off and on, the user is encouraged to try to correct the interference by one or more of the following measures:

1. Reorient or relocate the receiving antenna.
2. Increase the separation between the equipment and receiver.
3. Connect the equipment into an outlet on a circuit different from that to which the receiver is connected.
4. Consult the dealer or an experienced radio/TV technician for help.

1144 SERIES KEY FOB TRANSMITTERS

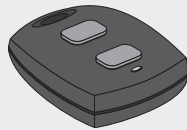

Specifications

Battery	
Life Expectancy	2 years (normal operation)
Type	3 V Lithium Sony CR2430
Dimensions	1.98" H x 1.53" W x 0.55" D 5.03 cm W x 3.89 cm H x 1.40 cm
Color	Black
Housing Material	ABS Plastic

Ordering Information

1144-D	Dual-Button Key Fob (includes optional encryption feature)
1144-1	One Button Key Fob (includes optional encryption feature)
1144-1P	One Button Key Fob with prox (includes optional encryption feature)
1144-1P-PSV	One Button Key Fob with prox and panic supervision mode (includes optional encryption feature)
1144-2	Two Button Key Fob (includes optional encryption feature)
1144-4	Four Button Key Fob (includes optional encryption feature)

Accessories

1144-HSG-B	Key fob replacement housing, black
CR2430/10	Key fob replacement battery, 10 pack

Compatibility

XTL Series Control Panels
Firmware Version 183 or higher

XT30/XT50 Control Panels
Firmware Version 183 or higher

XT75 Control Panels

XR Series Control Panels
Firmware Version 183 or higher

1100 Series Wireless Receivers
Firmware Version 300 or higher

 **Note:** To use wireless encryption, 1144 Series Wireless Key Fobs must have hardware Level 101 and firmware Version 200 or higher

Patents

U. S. Patent No. 7,239,236

Certifications

FCC Part 15 Registration ID CCKPC0098



Designed, engineered, and manufactured in Springfield, MO using U.S. and global components.

LT-1449 25011

© 2024

INTRUSION • FIRE • ACCESS • NETWORKS

2500 North Partnership Boulevard
Springfield, Missouri 65803-8877
800.641.4282 | DMP.com